

NOTES

1. Written dimensions take precedence over scaling.
2. Builder to verify all boundary setbacks prior to starting of works
3. Levels and contours are based on assumed datum. Prior to starting of works relevant authority to be contacted for possible minimum floor level req. and flood information
4. This site plan is based on disclosure plan. The floor level is subject to change. Additional site survey must be obtained for bench level.
5. Retaining walls greater than 1m high to be certified by qualified engineer, prior to B.A. approval. Retaining walls within 1500 of a boundary need building relaxation (fill side only)
6. Batters to comply with soil classifications as described in table 3.1.11 of BCA Vol. 2.
7. Vehicular crossover to be constructed as per local council requirements.
8. Scrape away vegetation, before cut and fill so as to provide a level building pad. Falls of 1:20 to be provided away from footings.
9. Termite protection in accordance with AS 3600.1

SERVICES

1. Prior to starting of works the relevant authority to be contacted for location of any underground services.
2. All household waste to be discharged to Local authority approved method of disposal.
3. Storm and roof water to be connected to a legal point of discharge in accordance with Part 3 BCA Vol 2 and local authorities requirements. All approvals to be obtained from authorities prior to starting of works.
4. Grade soil away from perimeter of building to prevent ponding. 1:20 surface fall towards gully pits. etc

LEGEND:

- B - BATH
- VB - VANITY BASIN
- FW - FLOOR WASTE
- SHR - SHOWER
- LDRY- LAUNDRY
- T - LAUNDRY TUB
- WM - WASHING MACHINE SPACE
- RF - REFRIGERATOR SPACE
- PTY - PANTRY
- WO - WALL OVEN
- MW - MICROWAVE
- HP - HOT PLATE
- RH - RANGEHOOD
- S - SINK
- DW - DISHWASHER
- DRW - DRAWER
- SWB- SLIDING WARDROBE DOOR
- RB - ROBE
- WIR- WALK IN ROBE
- HC- HOSE COCK

No	DESCRIPTION	DATE
H	FIRE WALL	31/08/18
G	JOIST	21/08/18
F	WINDOWS	20/07/18
E	DOOR & CARPET	20/07/18
D	COVENANT REVIEWED	27/6/18
C	LOUNGE REVIEWED	13/6/18
B	SIZE REVIEWED	6/6/18

DESCRIPTION
 All dimensions are in millimeters. Builder to check all dimensions prior to starting of works. Written dimensions take precedence over scaling. If in doubt ASK.

PRECISEBUILT
 Precision is Now Affordable
 Builder, Block & Bricklayer
 BSA 1230661
 No Job Too Big or Too Small
 Affordable Price
 All Job Guaranteed
 0418 462 707
 07 3470 1796
 website: www.precisebuilt.com.au email: info@precisebuilt.com.au

PROJECT:
PROPOSED 7 BEDROOM 2 STOREY HOUSE

SITE ADDRESS:
 Lot 195 SP 285041
 24 Madeira Street
 Springfield Lakes QLD 4300

CLIENT:
MR HUSSAINI

SHEET NO:	A04
SCALE:	1 : 100
DRAWING TITLE:	Ground Floor
PROJECT NO:	PBL-08.002
DATE:	10/09/18
DRAWN:	A.K.
CHECKED BY:	A.K.

1 **GROUND FLOOR**
 1 : 100

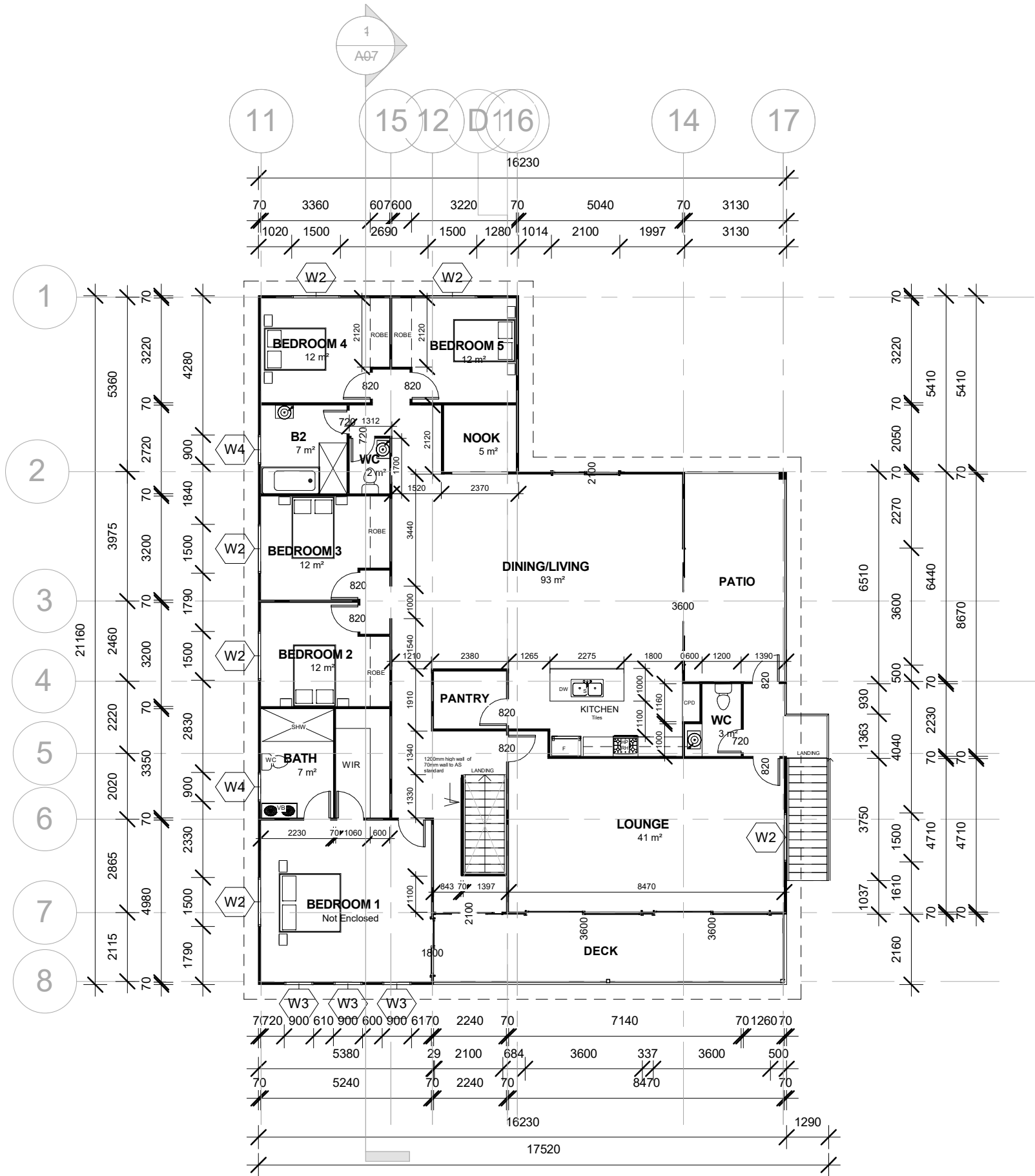

NOTES

1. Written dimensions take precedence over scaling.
2. Builder to verify all boundary setouts prior to starting of works
3. Levels and contours are based on assumed datum. Prior to starting of works relevant authority to be contacted for possible minimum floor level req. and flood information
4. This site plan is based on disclosure plan. The floor level is subject to change. Additional site survey must be obtained for bench level.
5. Retaining walls greater than 1m high to be certified by qualified engineer, prior to B.A. approval. Retaining walls within 1500 of a boundary need building relaxation (fill side only)
6. Batters to comply with soil classifications as described in table 3.1.11 of BCA Vol. 2.
7. Vehicular crossover to be constructed as per local council requirements.
8. Scrape away vegetation, before cut and fill so as to provide a level building pad. Falls of 1:20 to be provided away from footings.
9. Termite protection in accordance with AS 3600.1

SERVICES

1. Prior to starting of works the relevant authority to be contacted for location of any underground services.
2. All household waste to be discharged to Local authority approved method of disposal.
3. Storm and roof water to be connected to a legal point of discharge in accordance with Part 3 BCA Vol 2 and local authorities requirements. All approvals to be obtained from authorities prior to starting of works.
4. Grade soil away from perimeter of building to prevent ponding. 1:20 surface fall towards gully pits. etc

LEGEND:

- B - BATH
- VB - VANITY BASIN
- FW - FLOOR WASTE
- SHR - SHOWER
- LDRY - LAUNDRY
- T - LAUNDRY TUB
- WM - WASHING MACHINE SPACE
- RF - REFRIGERATOR SPACE
- PTY - PANTRY
- WO - WALL OVEN
- MW - MICROWAVE
- HP - HOT PLATE
- RH - RANGEHOOD
- S - SINK
- DW - DISHWASHER
- DRW - DRAWER
- SWB - SLIDING WARDROBE DOOR
- RB - ROBE
- WIR - WALK IN ROBE
- HC - HOSE COCK

No	DESCRIPTION	DATE
H	FIRE WALL	31/08/18
G	JOIST	21/08/18
F	WINDOWS	20/07/18
E	DOOR & CARPET	20/07/18
D	COVENANT REVIEWED	27/6/18
C	LOUNGE REVIEWED	13/6/18
B	SIZE REVIEWED	6/6/18

DESCRIPTION

All dimensions are in milimeters. Builder to check all dimensions prior to starting of works. Written dimensions take precedence over scaling. If in doubt ASK.



Ezat
Builder, Block & Bricklayer
BSA 1230661

PRECISEBUILT
Precision is Now Affordable

No Job Too Big or Too Small
Affordable Price
All Job Guaranteed

0418 462 707
07 3470 1796

website: www.precisebuilt.com.au email: info@precisebuilt.com.au

PROJECT:
PROPOSED 7 BEDROOM 2 STOREY HOUSE

SITE ADDRESS:
**Lot 195 SP 285041
24 Madeira Street
Springfield Lakes QLD 4300**

CLIENT:
MR HUSSAINI

SHEET NO: **A05**

SCALE: **1 : 150**

DRAWING TITLE: **First Floor**

PROJECT NO: **PBL-08.002**

DATE: **10/09/18**

DRAWN: **A.K.**

CHECKED BY: **A.K.**